

KEYED NOTES - EXISTING	
1	WALL
2	STAIRS
3	MANHOLE
4	LCRD PUMP BUILDING
5	
6	
7	
8	
8	
8	

KEYED NOTES - PROPOSED	
1	SEAWALL
2	STAIRS
3	ACCESSIBLE RAMP
4	BEACH AREA (GRAVEL / COBBLE STABILIZATION)
5	RIP-RAP STABILIZATION (REPLACEMENT)
6	RIP-RAP STABILIZATION (NEW)
7	SOFT STABILIZATION
8	PAVED (HMA) PARALLEL PARKING STALL
9	PAVED (HMA) ACCESSIBLE PARKING STALL
10	WHEEL STOP
11	NON-MOTORIZED DOCK
12	GANGWAY
13	ABUTMENT
14	VIEWING PLATFORM (BOARDWALK)
15	SIDEWALK
16	ACCESSIBLE ROUTE
17	PEDESTRIAN GUARDRAIL

KEYED NOTES - FUTURE (BY OTHERS)	
1	ABUTMENT
2	VIEWING PLATFORM (BOARDWALK)
3	SOFT STABILIZATION
4	PILE-SUPPORTED SWIM-BUOYS
5	
6	
7	
8	
1	

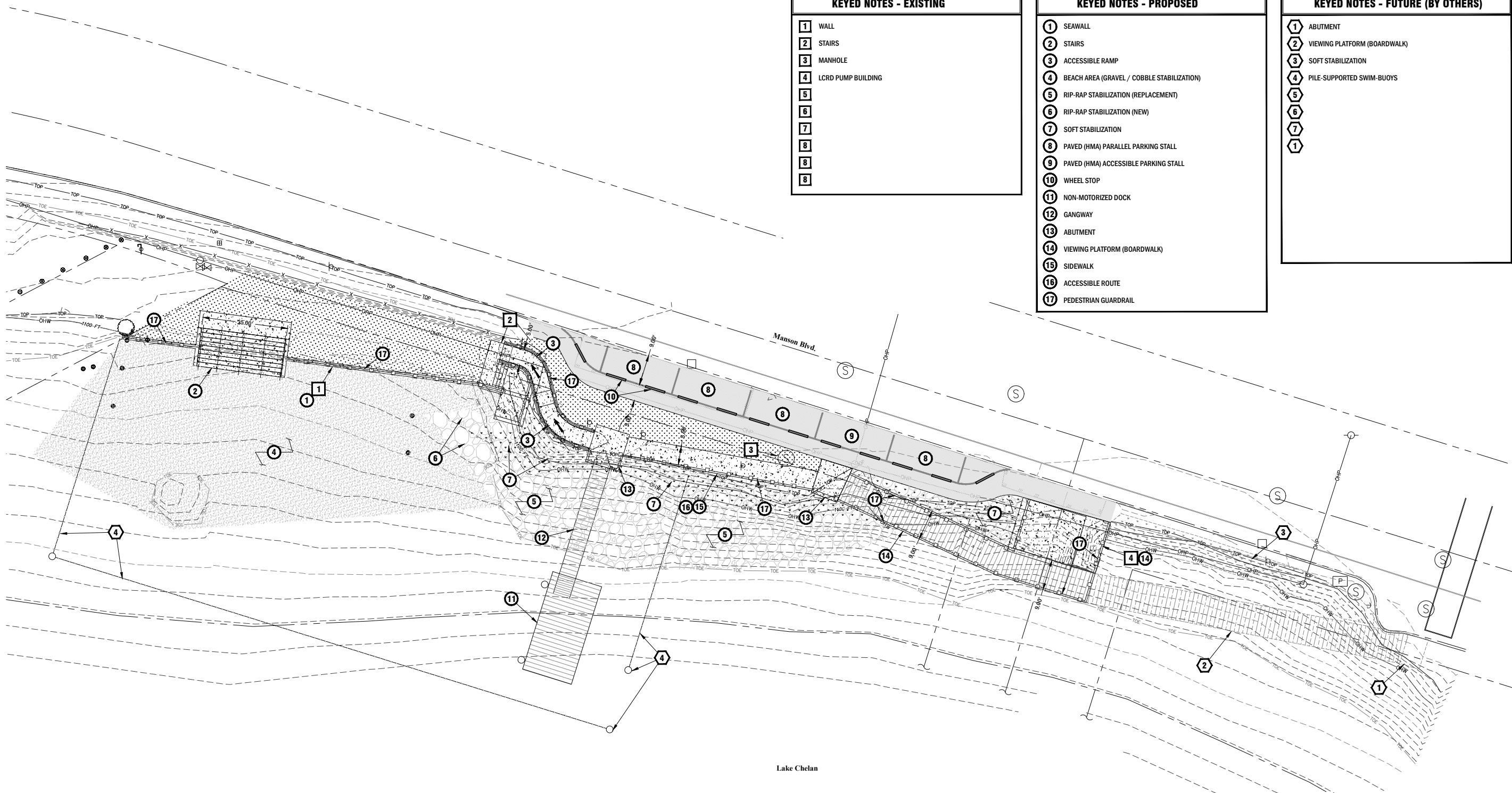

SITE PLAN
 (NOT TO SCALE)

LEGEND	
	RIGHT-OF-WAY LINE
	EASEMENT LINE
	PROPOSED HOT MIX ASPHALT
	PROPOSED CONCRETE
	PROPOSED GRAVEL SURFACING
	PROPOSED GRASS OR LANDSCAPING
	RIPRAP STABILIZATION
	SOFT (VEGETATED) STABILIZATION

REV	DATE	DESCRIPTION	REV	DATE	DESCRIPTION
0	06/24/2022	CONCEPT REVIEW			
1	07/13/2022	PARKING ALTERNATIVES			
2	07/20/2022	CONCEPT REVISION			

PACIFIC
ENGINEERING
200 S. COLUMBIA STREET, SUITE 300, WENATCHEE, WA 98801
 (509) 662-1101 www.pacificengineering.net

MANSON PARK AND RECREATION DISTRICT
OLD SWIM HOLE IMPROVEMENTS
PRELIMINARY
 MANSON, WA
 PROJECT NO. 21072CA

IF NOT ONE INCH ON THIS SHEET
 ADJUST SCALE ACCORDINGLY

SITE PLAN
C2.0